



FP-541, FP641, VP-420, I-820, MPL-35 Windows 11 Bluetooth installation

Download the I80 / I820 / FP541 / FP530 / FP530L / VP420 / MLP-35 driver from our web site:
<https://www.printek.com/windows-desktop/>. Unzip the downloaded file into a folder.

CONNECTING TO THE PRINTER THROUGH BLUETOOTH:

1. From Start menu select Settings
2. Select Devices
3. Select Bluetooth & other devices
4. Click the Arrow button for Devices

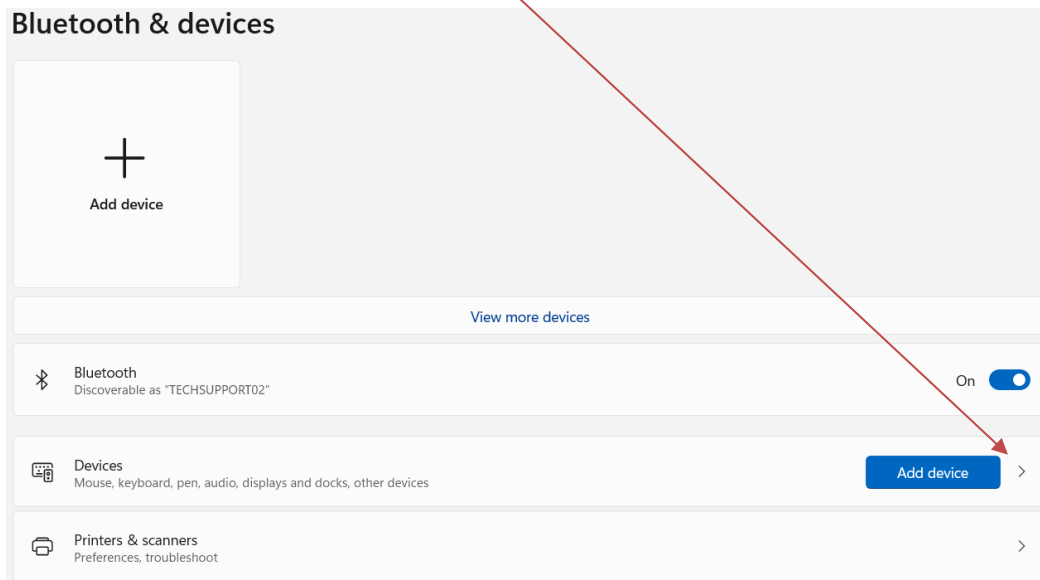



5. Change the Bluetooth devices discovery to **Advanced**.

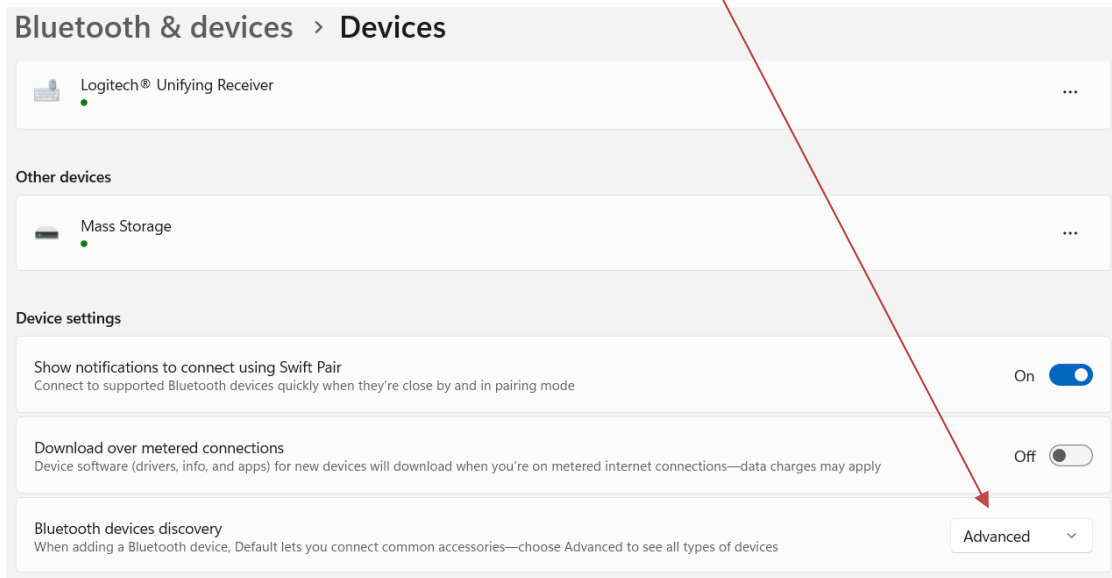

6. Go back to Bluetooth & devices
7. Select Add Device
8. Select Bluetooth
9. The printer will appear with a printer symbol next to it

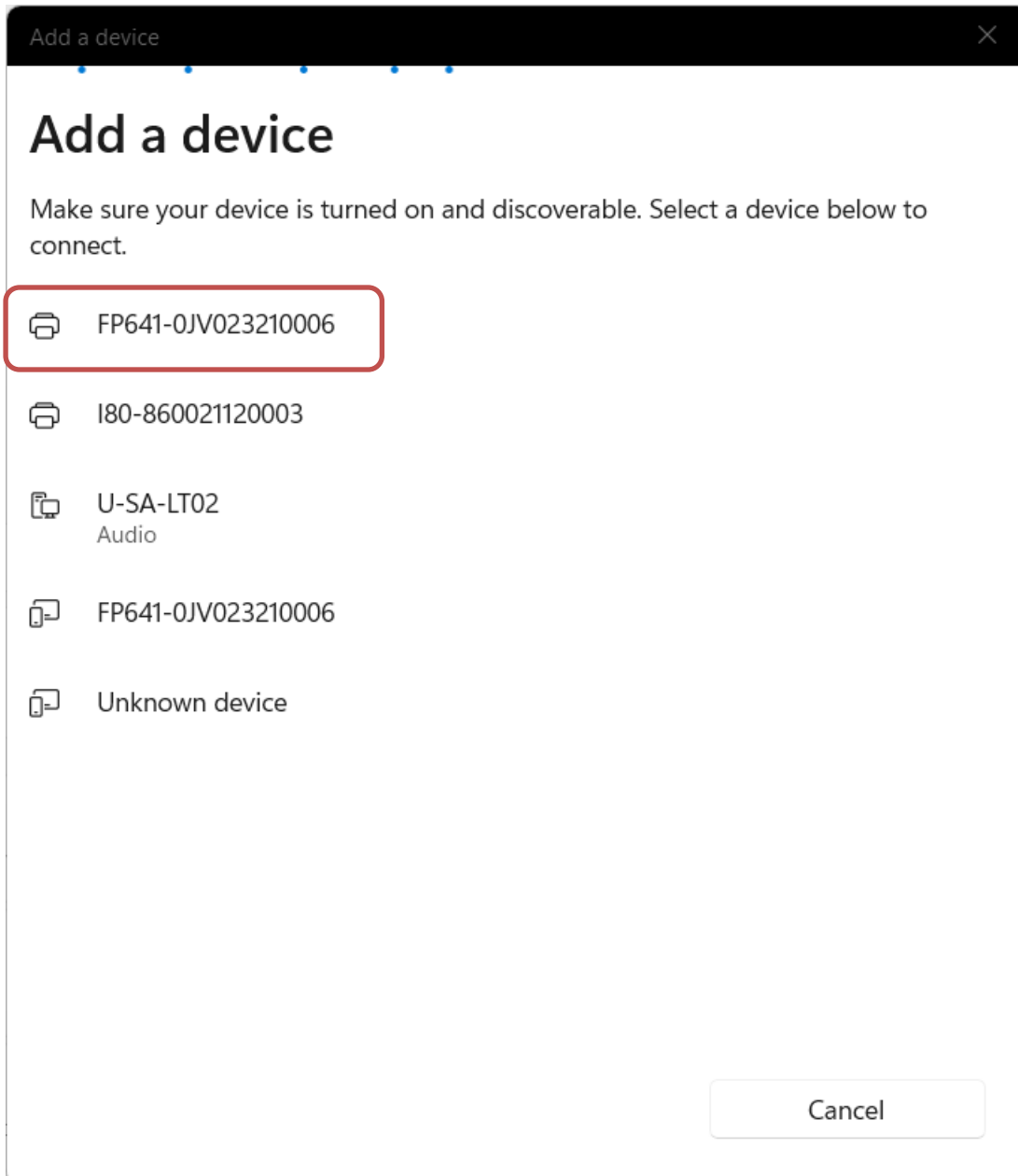

10. Select the printer.
11. The pin is 0000(4 zeros)
12. The paired printer will appear under Bluetooth & devices
 - a. Under the printer it will display Driver is unavailable.

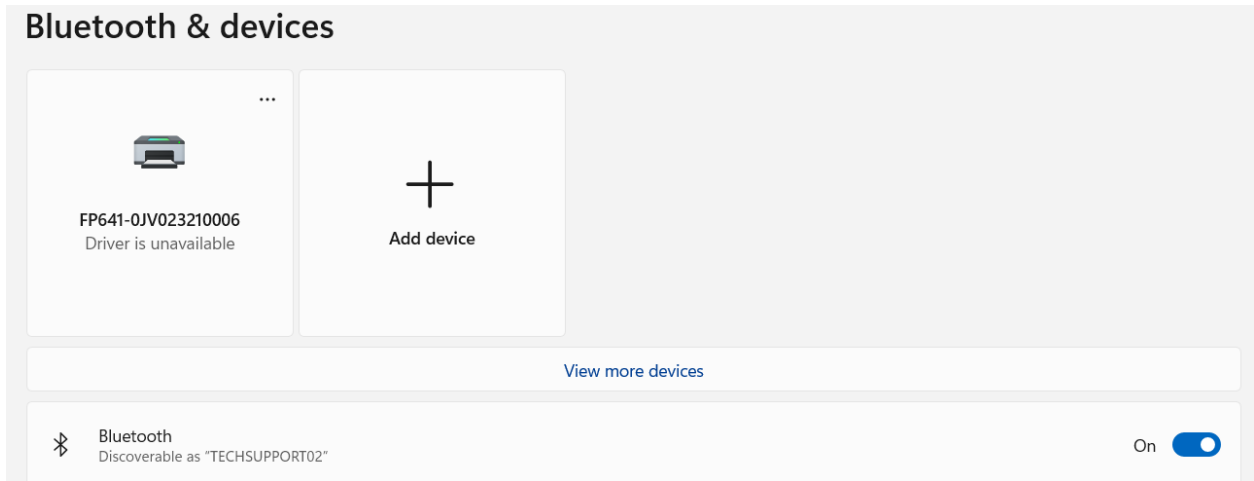

13. Select View more devices

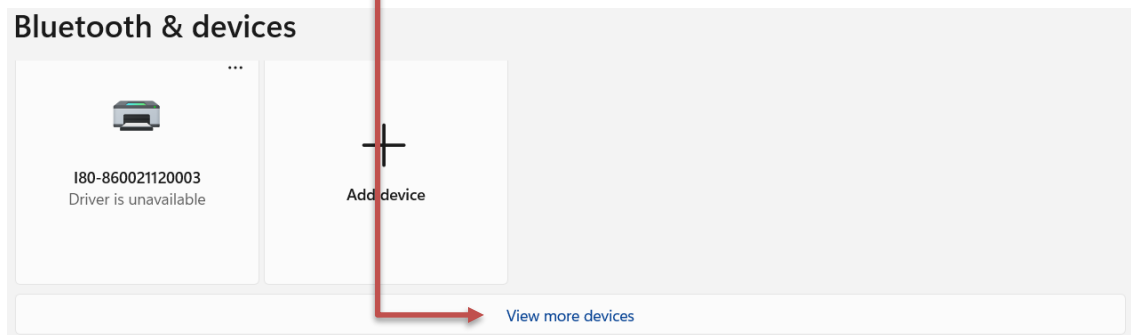

14. Scroll down to find **Related settings**

15. Select **More Bluetooth options**

16. Select the COM ports tab

17. Note the outbound COM Port number assigned to the printer. You will use this number when installing the printer driver.

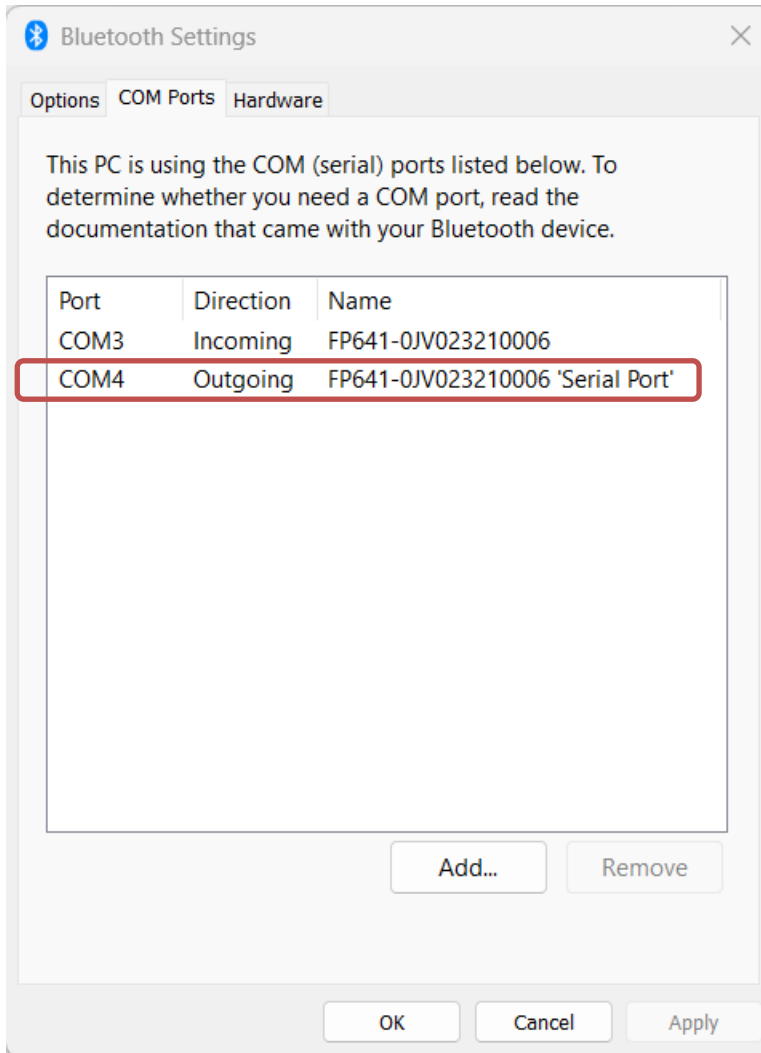

18. Select OK to close the window.



INSTALLING THE PRINTER DRIVER:

1. From the folder that you unzipped the driver files to select "DriverSetup"
2. Select Language you want the driver to be installed with
3. Select "OK"
4. Select "Next"
5. Select "Cancel" for manual installation
6. Select the printer model
7. Select "Next"
8. Select the COM port number you got from the Bluetooth settings.
 - a. If the COM port number is not listed restart your PC and restart the driver installation.
9. Select if you want this to be default printer
10. Select if you want to print a test page
11. Select "Next"
12. Verify the model and port setting is correct select "Finish"
13. A popup window will inform you the driver was successfully installed select "OK"
14. You should see the Printek model listed in your Printers & scanners



15. You will notice the printer is listed twice in the Printers & scanners.
 - a. The listing with the serial number is the Bluetooth connection.
 - b. The listing for the printer is the printer driver.